

Material Features:

- High-pressure die-casting aluminum body, external electrostatic powder spraying.
- High temperature proof silicon gasket and safety tempered glass / PC Prismatic diffuser
- Electric Box matched with different Reflectors to meet various requirements
- Adopting high coefficient heat conducting material and aluminum alloy for heat-releasing
- International top-ranking clip LED light source, quadratic optic non-imaging lens

Applicable places:

- Lighting for various Industrial Plants, Ware Houses, Shopping Complexes, Indoor Stadium etc.

IP65 Class I     

ELGC19-480L



Sealing Device,
Web Gaurd

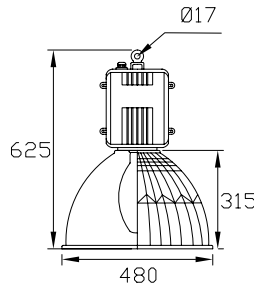

Light Distribution Curve
(Cd/1000lm)

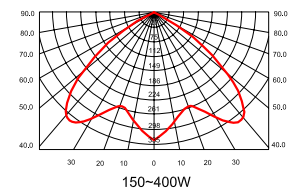

ELGC19-480PC



Sealing Device

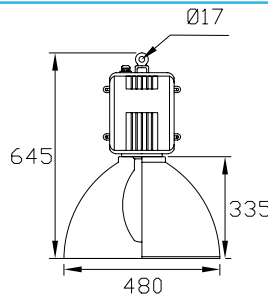

Light Distribution Curve
(Cd/1000lm)

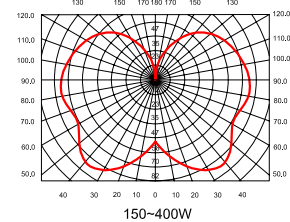

ELGC531- I (LED)

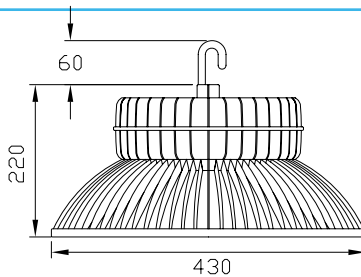

Light Distribution Curve
(Cd/1000lm)

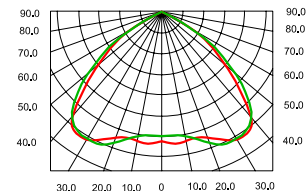

ELGC535- I, II (LED)

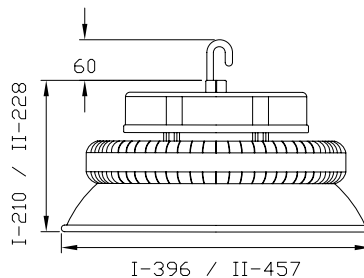

Light Distribution Curve
(Cd/1000lm)

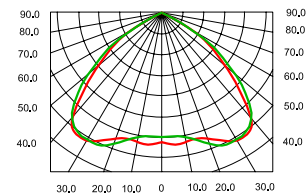

Model No	Light Source	Power W	Power factor pf	Input Voltage V/Hz	Lamp Type	Lamp Life Hr
ELGC19 - 480L	HPS / MH	150~400	>0.85	220~240V / 50-60Hz	E40	24000 / 12000
ELGC19 - 480PC	HPS / MH	150~400	>0.85	220~240V / 50-60Hz	E40	24000 / 12000
ELGC531 - I	LED	80, 95, 110	>0.85	220~240V / 50-60Hz	42, 84 Pcs LEDs	50000
ELGC535-I, II	LED	70, 95, 120, 140, 180	>0.85	220~240V / 50-60Hz	42, 70 Pcs LEDs 98 Pcs LEDs	50000